



TECHNICAL DATA SHEET

Passive Components

Kabelwerk | **EUPEN** AG

Rev.: 00/2005-08-18

cable

EPC-FA Fixed Attenuators 10 Watt

• Attenuation Value	dB	2	3	4	5	6	9	10	20	30
• Part Number N-Type F/F		EPC FA-A 10 006	EPC FA-A 10 007	EPC FA-A 10 008	EPC FA-A 10 009	EPC FA-A 10 010	EPC FA-A 10 011	EPC FA-A 10 012	EPC FA-A 10 013	EPC FA-A 10 014
• Part Number 7/16 DIN F/F		EPC FA-A 10 015	EPC FA-A 10 016	EPC FA-A 10 017	EPC FA-A 10 018	EPC FA-A 10 019	EPC FA-A 10 020	EPC FA-A 10 021	EPC FA-A 10 022	EPC FA-A 10 023
• Part Number N-Type F/M		EPC FA-A 10 024	EPC FA-A 10 025	EPC FA-A 10 026	EPC FA-A 10 027	EPC FA-A 10 028	EPC FA-A 10 029	EPC FA-A 10 030	EPC FA-A 10 031	EPC FA-A 10 032
• Part Number 7/16 DIN F/M		EPC FA-A 10 033	EPC FA-A 10 034	EPC FA-A 10 034	EPC FA-A 10 034	EPC FA-A 10 034	EPC FA-A 10 034	EPC FA-A 10 034	EPC FA-A 10 034	EPC FA-A 10 034
• Attenuation Accuracy	dB	± 0.5								
• Return Loss	dB	18								
• Frequency Range	MHz	DC to 2500 MHz								
• Impedance	Ω	50								
• Operating Temperature Range	°C	-20 to +55								
• Weigth N-Type	kg	0.207								
• Weigth 7/16 DIN	kg	0.299								
• Finish		Matt Black Anodised								

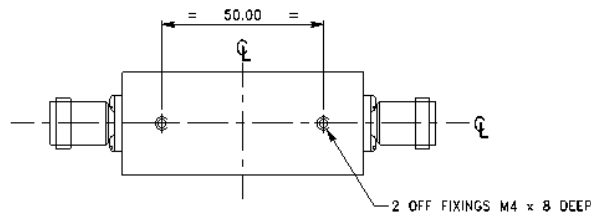
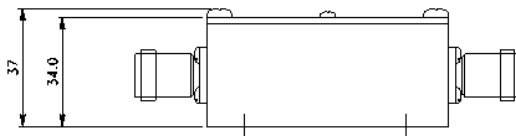
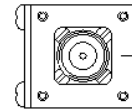
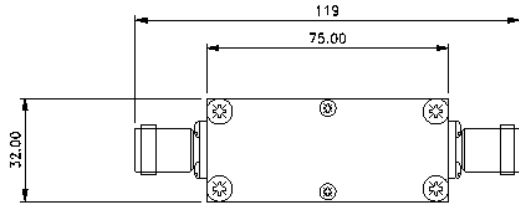

MATERIAL : ALUMINIUM ALLOY
 FINISH : BLACK ANODISE,CONNECTOR FACES CLEAN.
 CONNECTOR TYPE ; 'N' TYPE FEMALE,'N' TYPE MALE
 UNIT WEIGHT : 210g APPROX.

All measurements in mm